

Instructions for use

(D) (GB) (USA) (E) (F) (NL)

- (D) Zum Kleben von Quarzkomposit, Solid Surface, Naturstein und Keramik
- (GB) (USA) For bonding of quartz, solid surface, natural stone, ceramics and porcelain
- (E) Para pegar cuarzo compuesto, solid surface, piedra natural y cerámica
- (F) Pour coller composite de quartz, solid surface, pierre naturelle et céramique
- (NL) Voor het lijmen van kwartscomposiet, solid surface, natuursteen en keramiek



For professional
use only

SDS, TDS/Recycling:
scan here.



Test before use!

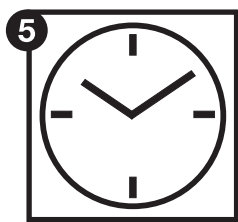
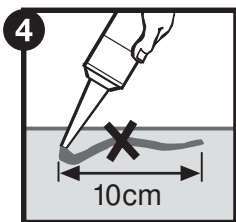
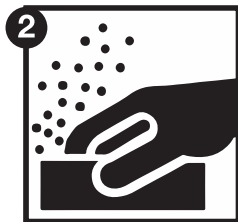

Potlife: 6 min
Curing: 20-30 min
(20°C/68°F)

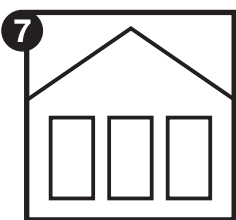
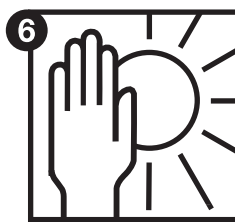

~ 1 year



For indoor use



Colour charts